

# PERMIT

**CITY OF NAPOLEON - BUILDING DEPARTMENT**  
 255 West Riverview Avenue, Napoleon, Ohio 43545 - 419-592-4010

Permit No. 01017 Issued 19APR85 date  
 Job Location 110 Briarcliff Drive address  
 Lot 88 Anthony Wayne Acres sub-div or legal discript  
 Issued By Richard N. [Signature] building official  
 Owner David and Carol Dill name 592-3689 tel.  
 Address 110 Briarcliff Drive  
 Agent Eldor Bruns builder-eng.-etc. 582-0250 tel.  
 Address Route 5  
 Description of Use Single Family Room Addition  
with Basement  
 Residential Single Family no. dwelling units  
 Commercial \_\_\_\_\_ Industrial \_\_\_\_\_  
 New \_\_\_\_\_ Add'n. XXXX Alter \_\_\_\_\_ Remodel \_\_\_\_\_  
 Mixed Occupancy \_\_\_\_\_  
 Change of Occupancy \_\_\_\_\_  
 Estimated Cost \$ 9,966.47

FEES	BASE	PLUS	TOTAL
BUILDING			24.00
ELECTRICAL	5.00	2.00	7.00
PLUMBING			
MECHANICAL			NA
DEMOLITION			
ZONING			
SIGN			
WATER TAP			
SEWER TAP			
TEMP. ELECT.			
ADDITIONAL PLAN REVIEW	Struct. _____ hrs	Elect. _____ hrs	
TOTAL FEES.....			31.00
LESS MIN. FEES PAID _____ date			-0-
BALANCE DUE.....			31.00

### ZONING INFORMATION

district <u>S Res</u>	lot dimensions	area	front yd <u>40</u>	side yds <u>15</u>	rear yd <u>20</u>
max hgt <u>35</u>	no pkg spaces <u>2</u>	no ldg spaces	max cover	petition or appeal req'd	date appr

### WORK INFORMATION:

Size: Length 22 Width 18 Stories One/Base Ground Floor Area 792  
 Height \_\_\_\_\_ Building Volume (for demo. permit) \_\_\_\_\_ cu. ft.  
 Electrical: \_\_\_\_\_ brief description \_\_\_\_\_  
 Plumbing: \_\_\_\_\_ brief description \_\_\_\_\_  
 Mechanical: \_\_\_\_\_ brief description \_\_\_\_\_  
 Sign: \_\_\_\_\_ type \_\_\_\_\_ Dimensions \_\_\_\_\_ Sign Area \_\_\_\_\_

Additional Information: \_\_\_\_\_  
 Date 4/19/85 Applicant Signature Carol R. Dill owner-agent  
PAID  
APR 19 1985  
CITY OF NAPOLEON

11770

DATE	DESCRIPTION	AMOUNT
10/20	...	...
10/21	...	...
10/22	...	...
10/23	...	...
10/24	...	...
10/25	...	...
10/26	...	...
10/27	...	...
10/28	...	...
10/29	...	...
10/30	...	...
10/31	...	...

TOTAL ...

CITY OF NAPOLEON  
 BUILDING INSPECTION DEPARTMENT  
 APPLICATION FOR BUILDING PERMIT  
 (Please print or type)

The undersigned hereby makes application for construction, installation, or alteration work as herein specified, agreeing to do all such work in strict accordance with the City of Napoleon's adopted Building Codes.

Location of project 110 Briarcliff Cost of project 9966.47  
 Owner's Name David + Carol Dill Address 110 Briarcliff  
 Contractor Elder Bruns Telephone No. 5920256  
 Address R. 5 Napoleon

Lot Information: (Not required for siding job)  
 Lot No. 88 Subdivision Anthony Wayne  
 Zoning District S Lot Size \_\_\_\_\_ ft. X \_\_\_\_\_ ft. Area \_\_\_\_\_ sq. ft.  
 Setbacks: Front \_\_\_\_\_ Right Side \_\_\_\_\_ Left Side \_\_\_\_\_ Rear \_\_\_\_\_

Work Information:  
 Residential  Commercial \_\_\_\_\_ Industrial \_\_\_\_\_  
 New Construction \_\_\_\_\_ Addition \_\_\_\_\_ Remodel \_\_\_\_\_  
 Accessory Building \_\_\_\_\_ Siding Alum

Brief Description of Work: ----- Basement 22 x 14 plus (Specific Type)  
Above Family rm. 22 x 18 with stair case  
 Size: Length 10x3 from existing fam. rm. Width 22 No. of Stories Base. + 1 story  
 Area: 1st Floor 342 sq. ft. Basement 308 sq. ft.  
 2nd Floor \_\_\_\_\_ sq. ft. Accessory Bldg. \_\_\_\_\_ sq. ft.  
 3rd Floor \_\_\_\_\_ sq. ft. Other \_\_\_\_\_ sq. ft.

Additional Information: Basement Contractor = John Machacek  
Wauseon, Ohio 43567 Ph = 335.3240

APPLICATION FOR PERMIT SHALL BE ACCOMPANIED BY TWO COMPLETE SETS OF PLANS INCLUDING: ELEVATIONS, FLOOR PLANS, CROSS SECTIONS AND PLOT PLAN. IF ADDITION OR REMODELING, SHOW ALL EXISTING STRUCTURES AND THEIR SIZE AND LOCATION. ALL PLANS SHALL BE DRAWN TO SCALE.

Date 4/19/85 Applicant's Signature Carol R. Dill

DRAW PLOT PLAN REVERS SIDE

PERMIT NO. 1017  
 PERMIT FEE \$ 24.00

Each square is 10'

PLOT PLAN

150'

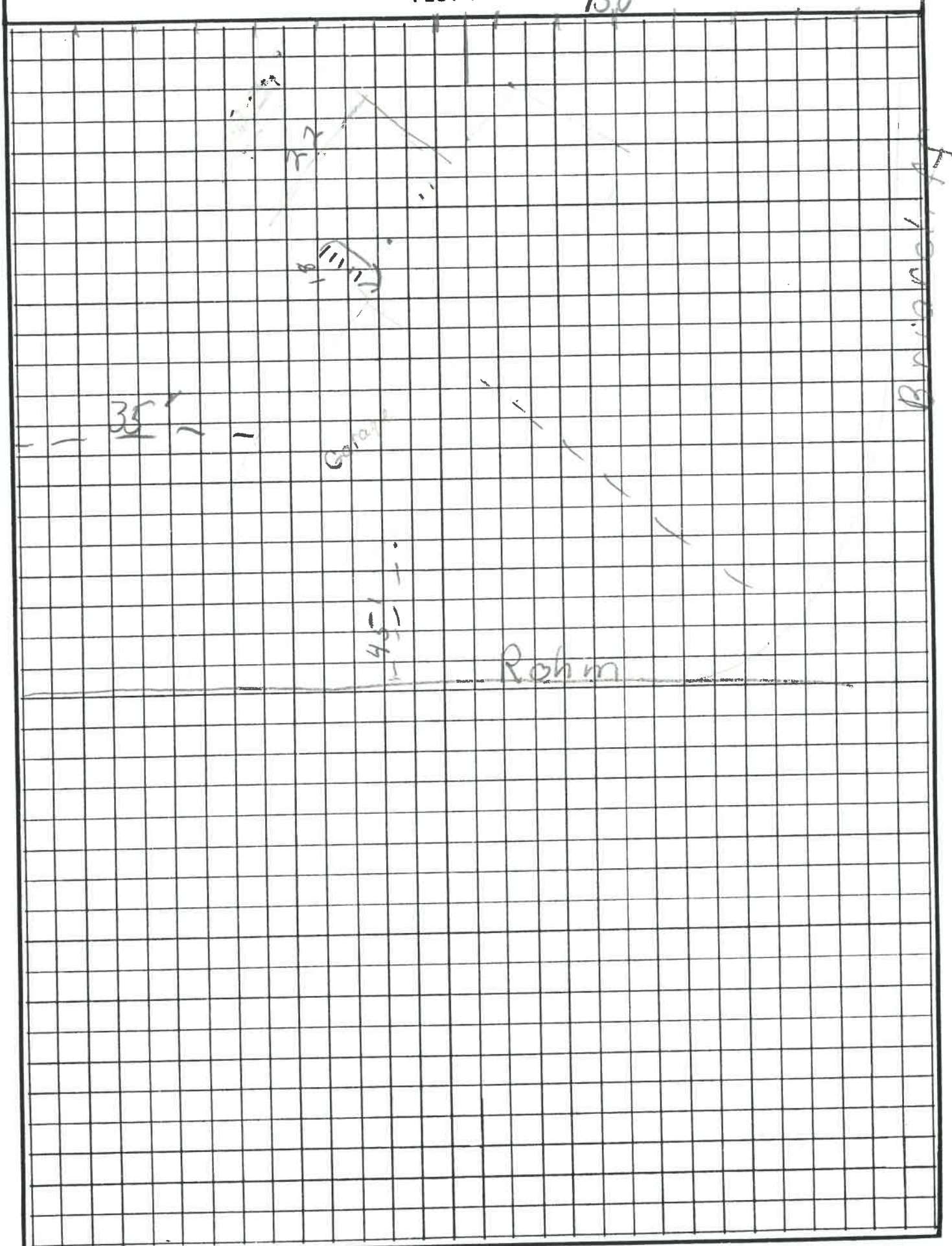

35'

Garage

45'

Room

Bridget

Each square is 10

PLOT PLAN

150'

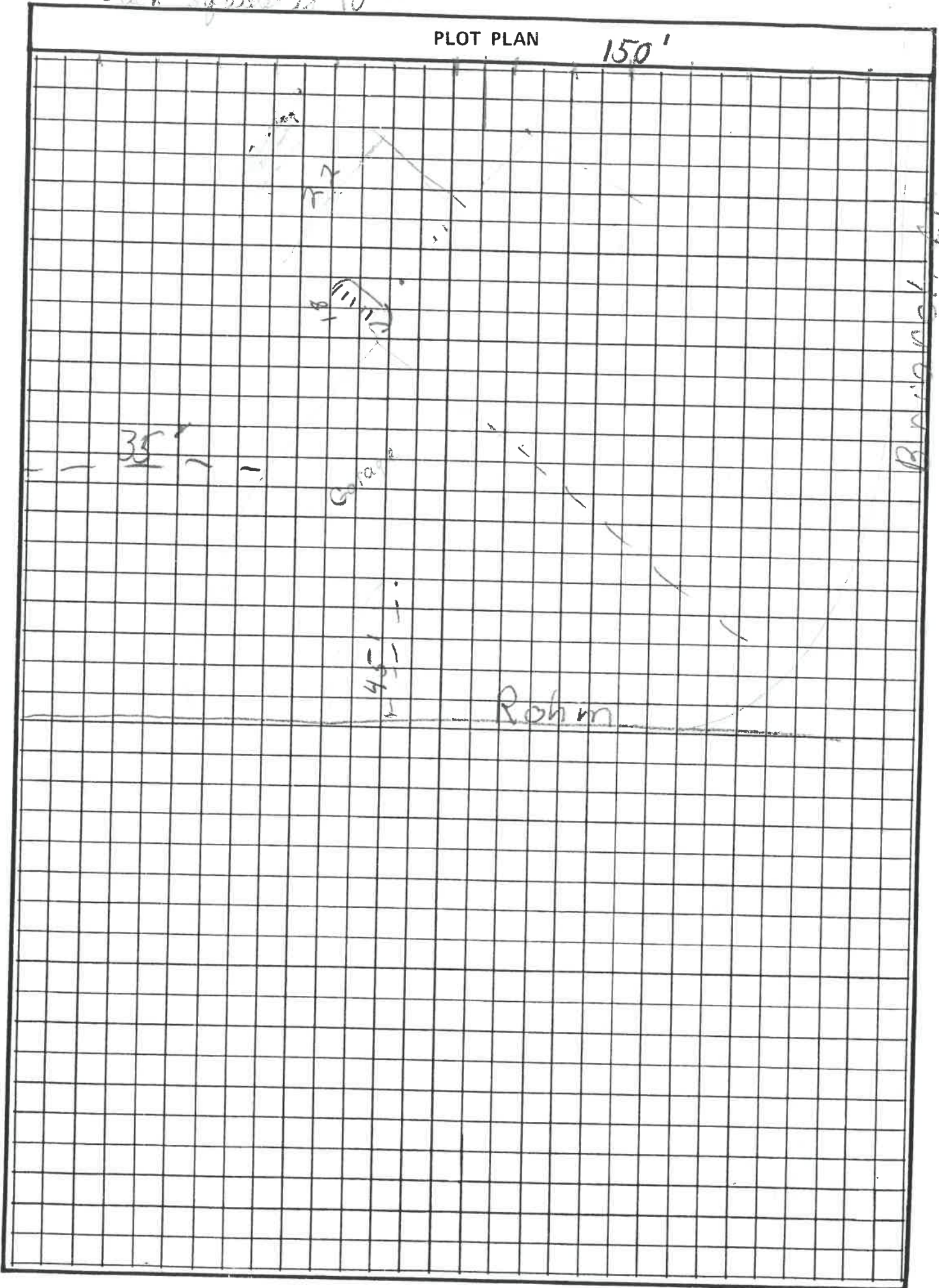

35'

60'

45'

Rohm

Bridges



CITY OF NAPOLEON  
 BUILDING DEPT.  
 Plan Approval  
 By RSH Date 1/19/85

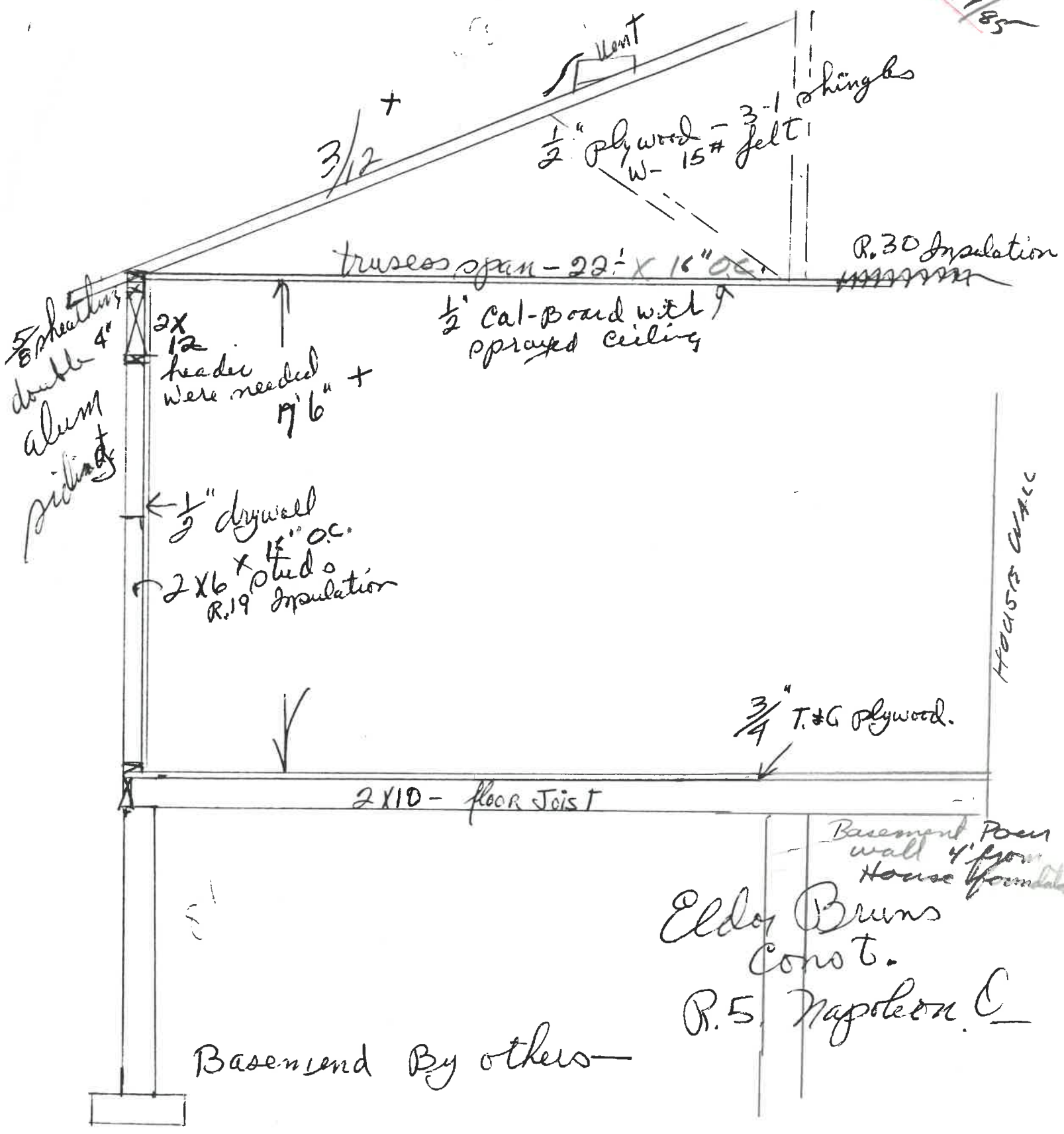





396 sq ft of 4" floor including ledge on 4" stone with inside tile, sump + vapor barrier



2 anderson windows

2' stone over tile

4' x 8" wall

8" x 16" footings, outside crawl tile, stone + waterproofing

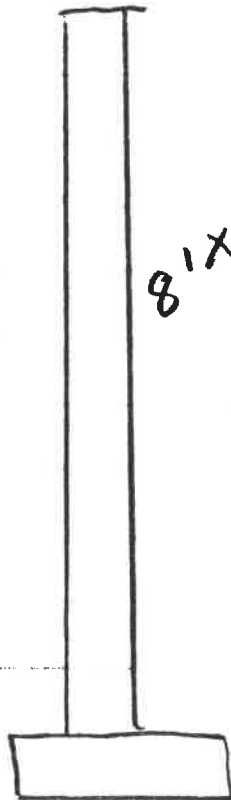

2 1/2" re rods continuous in footings

1/2" re rods 4' center vertically + 2' center horizontally in walls

8" x 16" footings outside tile + stone + waterproofing



# PERMIT

## CITY OF NAPOLEON - BUILDING DEPARTMENT

255 West Riverview Avenue, Napoleon, Ohio 43545 - 419-592-4010



**01017** Issued 19APR85  
date  
 Job on 110 Briarcliff Drive  
address  
 Lot 88 Anthony Wayne Acres  
sub-div or legal discript  
 Issued By [Signature]  
building official  
 Owner David and Carol Dill 592-3689  
name tel.  
 Address 110 Briarcliff Drive  
 Agent Eldor Bruns 592-0250  
builder-eng.-etc. tel.  
 Address Route 5  
 Description of Use Single Family Room Addition  
with Basement  
 Residential Single Family  
no. dwelling units  
 Commercial \_\_\_\_\_ Industrial \_\_\_\_\_  
 New \_\_\_\_\_ Add'n. XXXX Alter \_\_\_\_\_ Remodel \_\_\_\_\_  
 Mixed Occupancy \_\_\_\_\_  
 Change of Occupancy \_\_\_\_\_  
 Estimated Cost \$ 9,966.47

FEES	BASE	PLUS	TOTAL
BUILDING			24.00
ELECTRICAL	5.00	2.00	7.00
PLUMBING			
MECHANICAL			NA
DEMOLITION			
ZONING			
SIGN			
WATER TAP			
SEWER TAP			
TEMP. ELECT.			
ADDITIONAL PLAN REVIEW	Struct. _____ hrs	Elect. _____ hrs	
TOTAL FEES.....			31.00
LESS MIN. FEES PAID _____			- 0 -
BALANCE DUE.....			31.00

### ZONING INFORMATION

district S Res	lot dimensions	area	front yd 40	side yds 15	rear yd 20
max hgt 35	no pkg spaces 2	no ldg spaces	max cover	petition or appeal req'd	date appr

### WORK INFORMATION:

Size: Length 22 Width 18 Stories One/Base Ground Floor Area 792  
 Height \_\_\_\_\_ Building Volume (for demo. permit) \_\_\_\_\_ cu. ft.  
 Electrical: \_\_\_\_\_  
brief description  
 Plumbing: \_\_\_\_\_  
brief description  
 Mechanical: \_\_\_\_\_  
brief description  
 Sign: \_\_\_\_\_ Dimensions \_\_\_\_\_ Sign Area \_\_\_\_\_  
type

Additional Information: \_\_\_\_\_  
 Date 4/19/85 Applicant Signature Carol R. Dill  
owner-agent

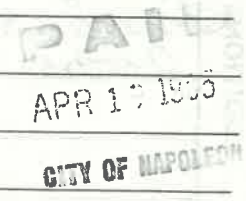

5/20/85 not started

# INSPECTION RECORD

	UNDERGROUND			ROUGH-IN						FINAL		
	Type	Date	By	Type	Date	By	Type	Date	By	Type	Date	
<b>PLUMBING</b>	Building Drains			Drainage, Waste & Vent Piping			Indirect Waste			Drainage, Waste & Vent Piping		
	Water Piping									Backflow Prevention		
	Building Sewer			Water Piping			Condensate Lines			Water Heater		
	Sewer Connection									FINAL APPROVAL		
<b>MECHANICAL</b>	Refrigerant Piping			Refrigerant Piping			Chimney(s)			Grease Exhaust System		
				Duct Furnace(s)			Fire Dampers			Air Cond. Unit(s)		
	Ducts/Plenums			Ducts/Plenums			<input type="checkbox"/> Radiant Htr(s) <input type="checkbox"/> Unit Htr(s)			Refrigeration Equipment		
				Duct Insulation			Pool Heater			Furnace(s)		
				Combustion Products Vents			Ventilation <input type="checkbox"/> Supply <input type="checkbox"/> Exhst.			FINAL APPROVAL		
<b>ELECTRICAL</b>	Conduits & or Cable			Conduits/Cable			<input type="checkbox"/> Range <input type="checkbox"/> Dryer			Temp Service Temp Lighting		
	Grounding & or Bonding			Rough Wiring			<input type="checkbox"/> Generator(s) <input type="checkbox"/> Motors			Fixtures Lampholders		
	Floor Ducts Raceways			Service Panel Switchboard			<input type="checkbox"/> Water Htr <input type="checkbox"/> Welder			Signs		
	Service Conduit			Busways Ducts			<input type="checkbox"/> Heaters <input type="checkbox"/> Heat Cable			Electric Mtr. Clearance		
	Temporary Power Pole			Subpanels			<input type="checkbox"/> Duct Htr(s) <input type="checkbox"/> Furnace(s)			FINAL APPROVAL		
<b>BUILDING</b>	Location, Set-backs, Esmt(s)	3/20/85	AKA	Exterior Wall Construction			Roof Covering Roof Drainage			Smoke Detector		
	Excavation	5/20/85	AKA				Exterior Lath			Demolition (sewer cap)		
	Footings & Reinforcing	4/20/85	AKA				<input type="checkbox"/> Interior Lath <input type="checkbox"/> Wallboard					
	Floor Slab			Interior Wall Construction			Fire Wall(s)			Building or Structure		
	Foundation Walls			Columns & Supports			Fireplace Chimney					
	Sub-soil Drain			Crawl Space <input type="checkbox"/> Vent <input type="checkbox"/> Access			Attic <input type="checkbox"/> Vent <input type="checkbox"/> Access					
	Piles			Floor System(s)						FINAL APPROVAL BLDG. DEPT.		
				Roof System			Special Insp Reports Rec'd			Certificate of Occupancy Issued	9/5/85 AKA	
<b>ADDITIONAL</b>	<b>INSPECTIONS, CORRECTIONS, ETC.</b>						<b>INSPECTIONS, CORRECTIONS, ETC.</b>					
	Staircase Basement need 3 ft landing Owner informed											

CITY OF NAPOLEON  
BUILDING INSPECTION DEPARTMENT  
APPLICATION FOR ELECTRICAL PERMIT  
(Please print or type)

The undersigned hereby makes application for installation or replacement of electrical equipment as herein specified, agreeing to do all such work in strict accordance with the City of Napoleon's adopted Electrical Codes.

Owner's Name David and Carol O'ill Address \_\_\_\_\_

Electrical Contractor David O'ill Telephone No. 592 3689

Address 110 Briarcliff

General Contractor Elder Bruns Telephone No. \_\_\_\_\_

Address \_\_\_\_\_

Location of Project \_\_\_\_\_ Cost of Project \_\_\_\_\_

Work Information:

Residential \_\_\_\_\_ Commercial \_\_\_\_\_ Industrial \_\_\_\_\_

No. Units

New \_\_\_\_\_ Service Change \_\_\_\_\_ Rewiring \_\_\_\_\_ Additional Wiring yes

Brief Description of Work: \_\_\_\_\_

Size of proposed service entrance same Number of new circuits 2

Type of proposed service entrance same Underground X Overhead ✓

Require Temporary Electric NO (Yes or No)

Total Floor Area - Commercial and Industrial only \_\_\_\_\_ sq. ft.

Additional Information: \_\_\_\_\_

\*Ground fault circuit interrupter protection is required on all 120-volt single phase, 15 and 20 amp. Circuits which are part of a temporary electric service: and also on bathroom, outdoor, and garage receptacles in all dwelling units. Art. 210-8 N.E.C.

\*Application for permit shall be accompanied by two complete sets of plans including: Electrical layout and riser diagram. (For commercial and industrial work only).

Date 4/19/85 Applicant's Signature Carol R. O'ill

PERMIT NO. 1017  
PERMIT FEE \$ 7.00



CITY OF NAPOLEON  
BUILDING INSPECTION DEPARTMENT  
APPLICATION FOR HEATING PERMIT  
(PLEASE PRINT OR TYPE)

The undersigned hereby makes application for the installation, replacement or alteration of a heating system or device as herein specified, agreeing to do all such work in strict accordance with the City of Napoleon's adopted Mechanical Code for 1, 2 and 3 Family Buildings.

Owner's Name David Dill Address 110 Briarcliff

Contractor's Name David Dill Address Same Tel. \_\_\_\_\_

BUILDING INFORMATION:

592 3689

Single Family  Double Family \_\_\_\_\_ Multiple \_\_\_\_\_ New Construction \_\_\_\_\_

Addition  Remodel \_\_\_\_\_ Replacement \_\_\_\_\_ No. of Stories \_\_\_\_\_

DESCRIPTION OF WORK

Heating System - Warm Air  Hot Water \_\_\_\_\_ Steam \_\_\_\_\_ Electric \_\_\_\_\_

Unit Heaters \_\_\_\_\_ Unit Gas Heaters  Other \_\_\_\_\_

Type - Gravity \_\_\_\_\_ Forced  Radiant \_\_\_\_\_

No. of Thermostatical Heating Zone 1

Hot Water - One Pipe \_\_\_\_\_ Two Pipe \_\_\_\_\_ Series Loop \_\_\_\_\_

Electric Heat - No. of Circuits \_\_\_\_\_ Other \_\_\_\_\_

Total Heat Loss of Area to be Heated \_\_\_\_\_ Btu.

Rated Capacity of Furnace/Boiler \_\_\_\_\_ Btu.

No. of Furnaces 1 No. of Hot Air Runs NO

No. of Hot Water Radiators \_\_\_\_\_ Type of Fuel Gas

Heating Units Located: Crawl Space \_\_\_\_\_ Floor Level  Suspended \_\_\_\_\_

Roof or Exposed to Outside Air \_\_\_\_\_ Attic \_\_\_\_\_ Other \_\_\_\_\_

APPLICATION FOR PERMIT SHALL BE ACCOMPANIED BY TWO COMPLETE SETS OF PLANS INCLUDING: LOCATION OF FURNACE OR UNIT HEATERS AND SIZE AND LOCATION OF FEEDER DUCTS AND RETURN AIR DUCTS. ALL PLANS SHALL BE DRAWN TO SCALE.

ESTIMATED COST OF COMPLETED PROJECT: \_\_\_\_\_

DATE 4/19/85 APPLICANT'S SIGNATURE Carol R. Dill

OWNER-CONTRACTOR-AGENT

Fri.  
3:00 - Richard Hayman  
2 Hot air } To be connected to  
1 cold return } furnace

# Inspection

1. Location OK Stake now  
before concrete
2. Look at footer - before pouring  
2 hr. notice - John - day of dig
3. Look at wall concret as pouring  
Sump - put in now +  
ask for sump drainage + stone
4. Look at frame work + elec. wire  
before hook up
5. Final -

Fri.  
3:00  
Inspection